

Sold

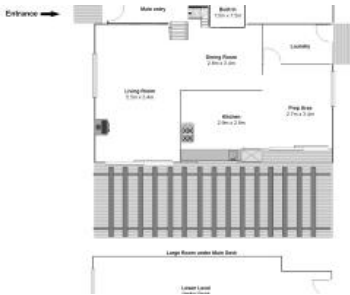

38 Thompson St, Scotland Island



A Spacious and Convenient Family Home

Positioned on a large and private 1100sqm corner block this tri level cedar home features lime washed bamboo flooring throughout and ducted air conditioning.

The spacious and open plan lower level consists of a modern cafe style kitchen, dining room and lounge area which boasts a combustion heater and skylight. This level leads onto a large full width covered entertaining deck which has a lovely outlook through trees over the easy care garden and a netted area used as a basket ball court.

A side second deck leads to a storage shed and provides access to the large separate fifth bedroom or home office.

The second level contains the main bedroom with a new ensuite, walk in wardrobe and an office space or reading nook. On this level there is also the main bathroom and another bedroom.

Two double bedrooms are on the top level both having large picture windows with one bedroom having access to a large ceiling storage area.

5 2 1,100 m²

Price	SOLD
Property Type	Residential
Property ID	153
Land Area	1,100 m ²

Agent Details

Melanie Marshall - 0415 440 662

Office Details

PMC Hill Real Estate
02 9999 4902



The landscaped grounds contain a separate cabin which makes an ideal teenager retreat or home office. Under the home is more storage space and a workshop area.

This convenient and spacious home provides an exceptional opportunity for a family looking for a unsurpassed life style on Pittwater.

The above information provided has been furnished to us by the vendor/s. We have not verified whether or not that information is accurate and do not have any belief in one way or the other in its accuracy. We do not accept any responsibility to any person for its accuracy and do no more than pass it on. All interested parties should make and rely upon their own inquiries in order to determine whether or not this information is in fact accurate.